

SUMMARY

Wires

Low	4
High	0
Coax	0
Triax	0
Quad	0
Fiber	0
Fluidic	0

Series	P
Termination type	Female crimp
IP rating	50
Cable Ø	0.00 - 0.00 mm
Matching parts	PAG.M0.4NL.CC39N
Status	active
Alternative part	



Image is for illustrative purpose only

Download

[Request a quote](#)

[Catalog](#)

TECHNICAL DETAILS

Mechanics

Shell Style/Model	PK*: Fixed receptacle with two nuts (back panel mounting)
Keying	1 key (alpha=0; Plug: male contact; Receptacle: female contact)
Housing Material	PSU (Polysulfone), black
Cable Fixing	∅ 0 - 0 mm
Variant	Z : without front nut
Weight	5.60 g

Performance

Configuration	1P.M04 : 4 Low Voltage
Insulator	
Rated Current	8 Amps

Specifications

Contact Type: Crimp
Max. Matings: 2000
Contact Retention: 24 N

LEMO products and services are provided "as is". LEMO makes no warranties or representations with regard to LEMO product & services or use of them, express, implied or statutory, including for accuracy, completeness, or security. The user is fully responsible for his products and applications using LEMO components.

Contact Dia.: 0.9 mm (0.0354in)
Min. Conductor: 0.5 mm² (AWG 20)
Max. Conductor: 0.25 mm² (AWG 24)
R (max): 4.5 mOhm
Test voltage (kV rms) Contact-contact: 1.2
Air clearance min. (mm) or Creepage distance min. (mm): 1.2

Others

F ret (min): 50 N
F ret (max): 150 N
IP Rating: 50

DRAWINGS

Draws

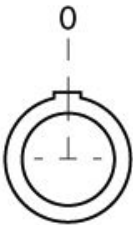
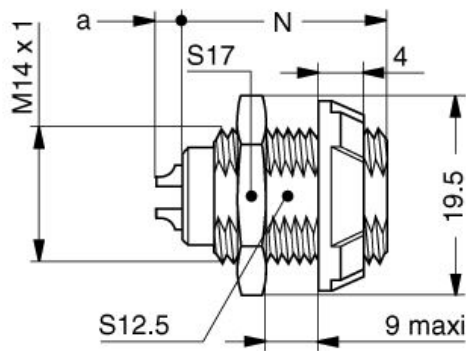

Dimensions

	A	Lmax
mm.	19.5	33.5
in.	0,77	1,32

RECOMMENDED BY LEMO

Tools

Crimp Tool: DPC.91.701.V
Crimp settings: AWG/Selector = 20-22-24/6-5-5

LEMO products and services are provided “as is”. LEMO makes no warranties or representations with regard to LEMO product & services or use of them, express, implied or statutory, including for accuracy, completeness, or security. The user is fully responsible for his products and applications using LEMO components.

Positionner: DCE.91.090.BVM

Extractor: DCF.91.090.2LT

Replacement contact: SINGLE: EGG.0B.664.ZZM KIT OF 4: PKG.662.04M

Cables

LEMO products and services are provided "as is". LEMO makes no warranties or representations with regard to LEMO product & services or use of them, express, implied or statutory, including for accuracy, completeness, or security. The user is fully responsible for his products and applications using LEMO components.