

SUMMARY

Wires

| | |
|---------|---|
| Low | 4 |
| High | 0 |
| Coax | 0 |
| Triax | 0 |
| Quad | 0 |
| Fiber | 0 |
| Fluidic | 0 |

| | |
|------------------|------------------|
| Series | P |
| Termination type | Female print PCB |
| IP rating | 50 |
| Cable Ø | 0.00 - 0.00 mm |
| Matching parts | PAG.M0.4TL.AC39N |
| Status | active |
| Alternative part | |



Image is for illustrative purpose only

Download

[Request a quote](#)
[PCB Eagle Pattern](#)
[PCB Altium Pattern](#)
[Catalog](#)

TECHNICAL DETAILS

Mechanics

| | |
|-------------------|--|
| Shell Style/Model | PK*: Fixed receptacle with two nuts (back panel mounting), straight print contacts |
| Keying | 1 key (alpha=0; Plug: male contact; Receptacle: female contact) |
| Housing Material | PEI (Polyetherimide), black |
| Cable Fixing | ∅ 0 - 0 mm |
| Variant | N : Black front nut |
| Weight | 4.84 g |

Performance

| | |
|---------------|------------------------|
| Configuration | 1P.M04 : 4 Low Voltage |
| Insulator | |
| Rated Current | 8 Amps |

Specifications

| |
|---------------------------------|
| Contact Type: Print (straight) |
| Max. Matings: 2000 |
| Contact Dia.: 0.9 mm (0.0354in) |

LEMO products and services are provided "as is". LEMO makes no warranties or representations with regard to LEMO product & services or use of them, express, implied or statutory, including for accuracy, completeness, or security. The user is fully responsible for his products and applications using LEMO components.

R (max): 4.5 mOhm
Test voltage (kV rms) Contact-contact: 1.2
Air clearance min. (mm) or Creepage distance min. (mm): 1.2

Others

F ret (min): 50 N
F ret (max): 150 N
IP Rating: 50

DRAWINGS

Draws

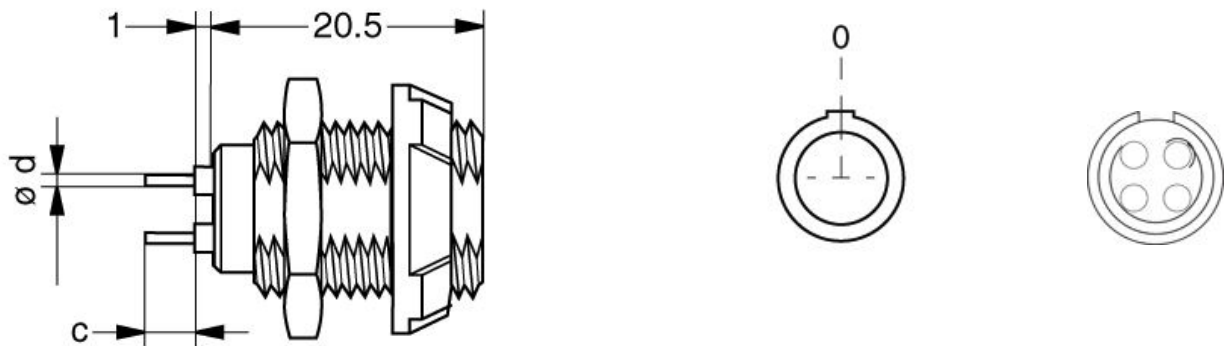

Dimensions

| | A | L | N |
|-----|------|------|------|
| mm. | 19.5 | 26.5 | 20.5 |
| in. | 0,77 | 1,04 | 0,81 |

RECOMMENDED BY LEMO

Tools

None

Cables

LEMO products and services are provided “as is”. LEMO makes no warranties or representations with regard to LEMO product & services or use of them, express, implied or statutory, including for accuracy, completeness, or security. The user is fully responsible for his products and applications using LEMO components.

LEMO products and services are provided "as is". LEMO makes no warranties or representations with regard to LEMO product & services or use of them, express, implied or statutory, including for accuracy, completeness, or security. The user is fully responsible for his products and applications using LEMO components.